

Tektronix Probe Project

ME 492-493, 2006

High Performance O-Scope

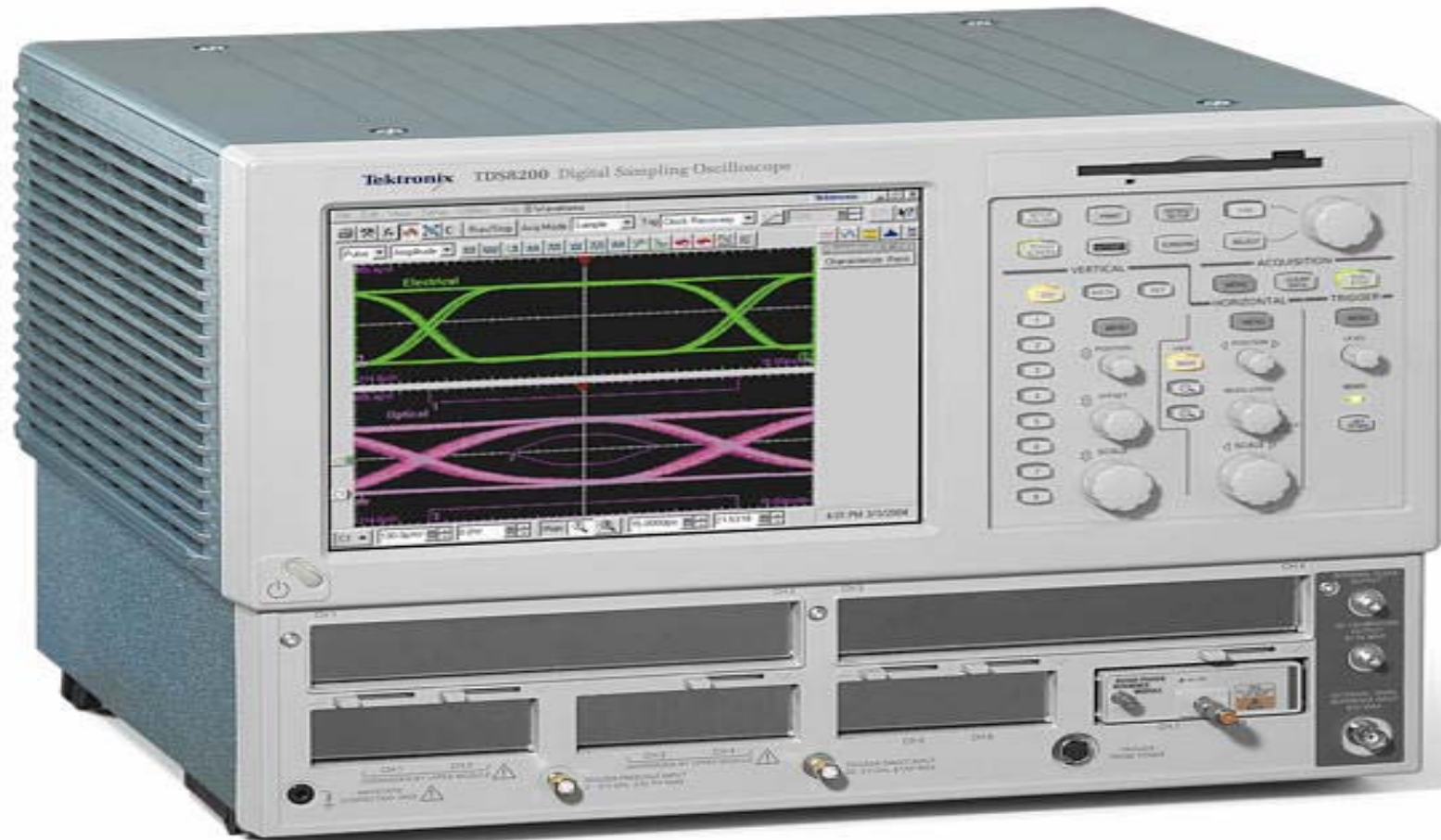

Signal Probes



Probe Geometry

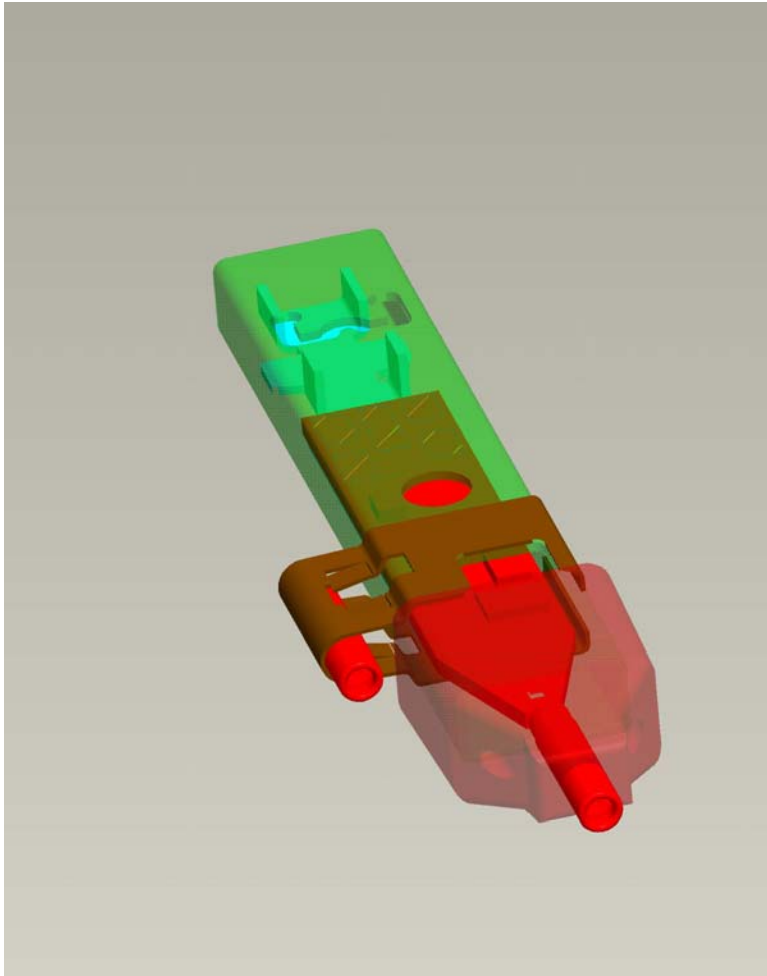

Electronic circuit in tip

- Essential for high speed
- Heat dissipation limits performance

Probe Assembly

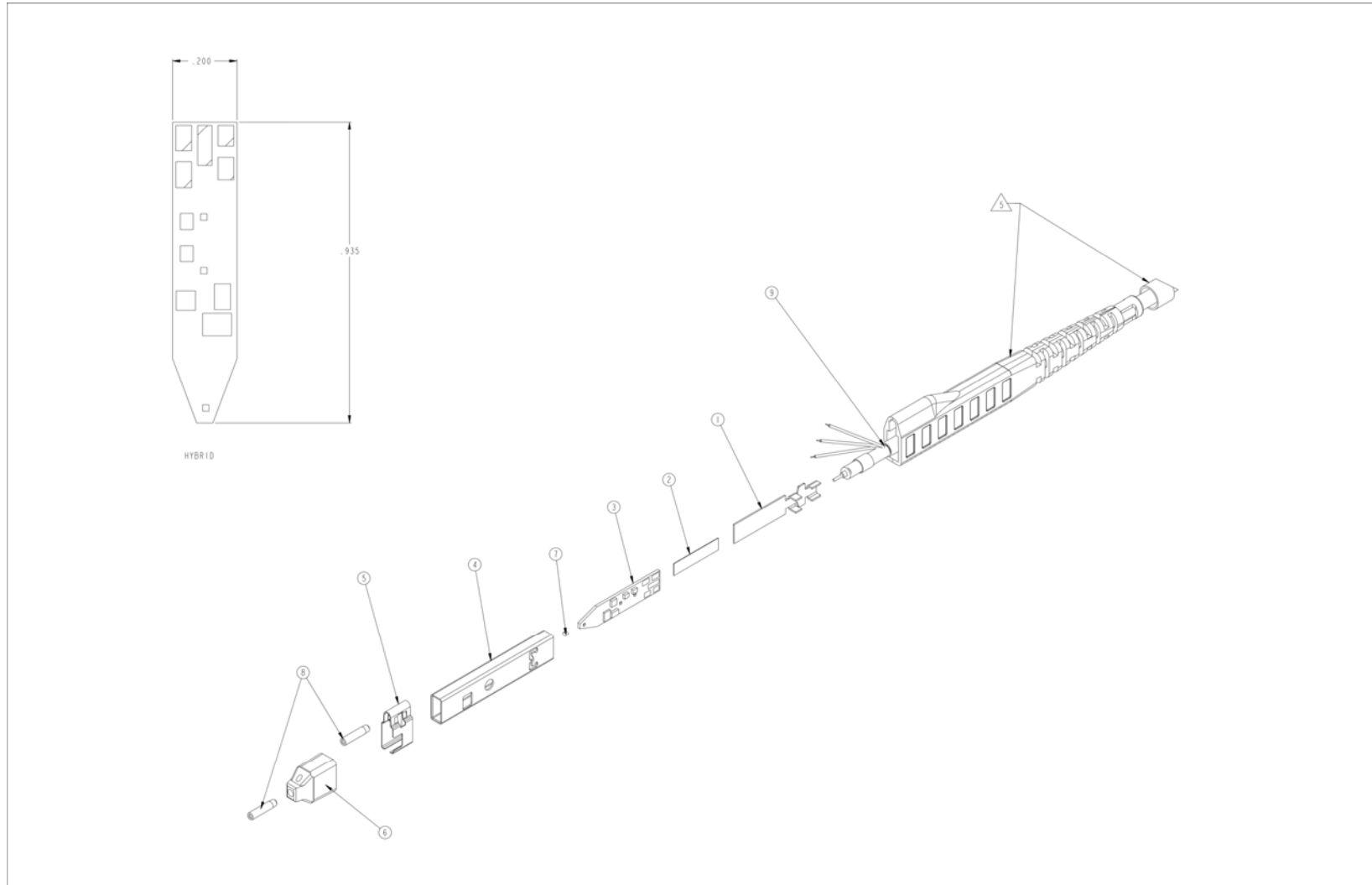

Project

- Design probe tip capable of 2X increase in power dissipation
- Access to state-of-the-art machine shop
- First class industrial advisor
 - Chris Coleman, MSME, Tek Engineer
 - EE support from Tek
- Design will involve thermal, mechanical, electrical, and materials considerations

For Fun

An OSU Team will be working on their own version of this project

